

MINI

Bassinet

Compatible with the Britax Mini stroller.
(sold separately)



0_{KG}

9_{KG}

(newborn – 6 months approx.)

IMPORTANT KEEP THIS
BOOKLET IN A SAFE PLACE
FOR FUTURE REFERENCE

About Your Bassinet	Warnings & Important Notes	03
	Lift & Carry Correctly	04
	What's in the Box: Bassinet Parts	05
	Compatibility	05
	Bassinet Features	06
Bassinet Assembly	Opening the Bassinet	08
	Attaching the Liner	09
	Inserting the Mattress Pad	09
Bassinet Operation	Using the Canopy	10
	Attaching the Bassinet Cover	10
	Attaching the Bassinet to the Stroller frame	11
	Removing the Bassinet to the Stroller frame	11
	Using the View & Ventilation Panels	12

Bassinet Accessories	Attaching the Rain Cover	13
	Attaching the Sun Shade	13
Care & Maintenance	Care & Maintenance	14
	Warranty	17
	Notes	19

WARNINGS

- **DO NOT USE FOR UNSUPERVISED SLEEPING.**
- **DO NOT USE THE BASSINET ONCE THE CHILD CAN SIT UP UNAIDED.**
- **DO NOT USE ANY ACCESSORIES OTHER THAN THOSE APPROVED FOR USE WITH THIS STROLLER BY BRITAX.**
- **IT IS UNSAFE TO USE ACCESSORIES NOT APPROVED FOR USE WITH THIS STROLLER.**
- **THE BASSINET CAN ONLY BE USED ON THE STROLLER FRAME, IT CAN NOT BE USED AS A STAND ALONE BASSINET.**
- **THE MAXIMUM WEIGHT OF THE CHILD USING THE BASSINET IS NOT TO EXCEED 9KGS.**

IMPORTANT NOTES:

- The Britax Mini bassinet is designed to fit the Britax Mini stroller.
- Remove the stroller seat or baby capsule from the frame before fitting the bassinet.
- Always remove your child from the bassinet before fitting or removing the bassinet from the stroller frame.
- The bassinet must always be on parent facing mode (facing handlebar).
- The bassinet must be removed from the frame before folding.
- Do not lift the stroller by the bassinet.

Lift & Carry Correctly

The SMART lifting technique: This technique can be used to pick up small light loads from low levels.

Size up the load

- Assess the load (size, shape, and weight).
- Assess whether the load needs to be moved;
- Where is it going to be placed? Check that there are no obstructions;
- Assess whether mechanical or human assistance is required.

Move the load as close to the body as possible

- A load is heavier to lift or carry if it is not close to the body.
- The whole hand should be used to ensure a firm grip.

Always bend your knees

- Maintain balance.
- Keep feet apart and in a comfortable position.
- Minimise lower back bending.
- Bend knees preferable at as large an angle as possible but not at a right angle - use a semi-squat in preference to a full squat.

Raise the load with your legs

- Achieve the lift smoothly and without jerkiness.
- Maintain the normal curvature of the spine to allow the force of the load to be distributed evenly from the spine to the pelvis.

Turn your feet in the direction that you want to move the load.

- Avoid unnecessary bending, twisting, and reaching.
- Change direction by turning your feet and not your back.
- To set the load down, squat down, keep your head up and let your legs do the work.

Remember to **THINK TALL** - chest lifted, shoulders relaxed, chin tucked in, and head level.

What's in the Box: Bassinet Parts

1 x Frame

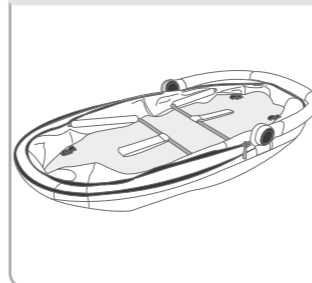

1 x Liner



1 x Mattress Pad

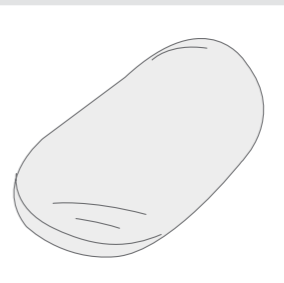

1 x Canopy

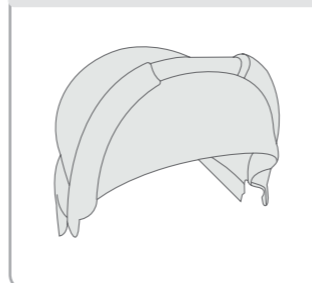

1 x Bassinet Cover

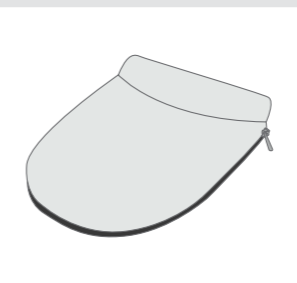

Compatible with: Britax Mini stroller

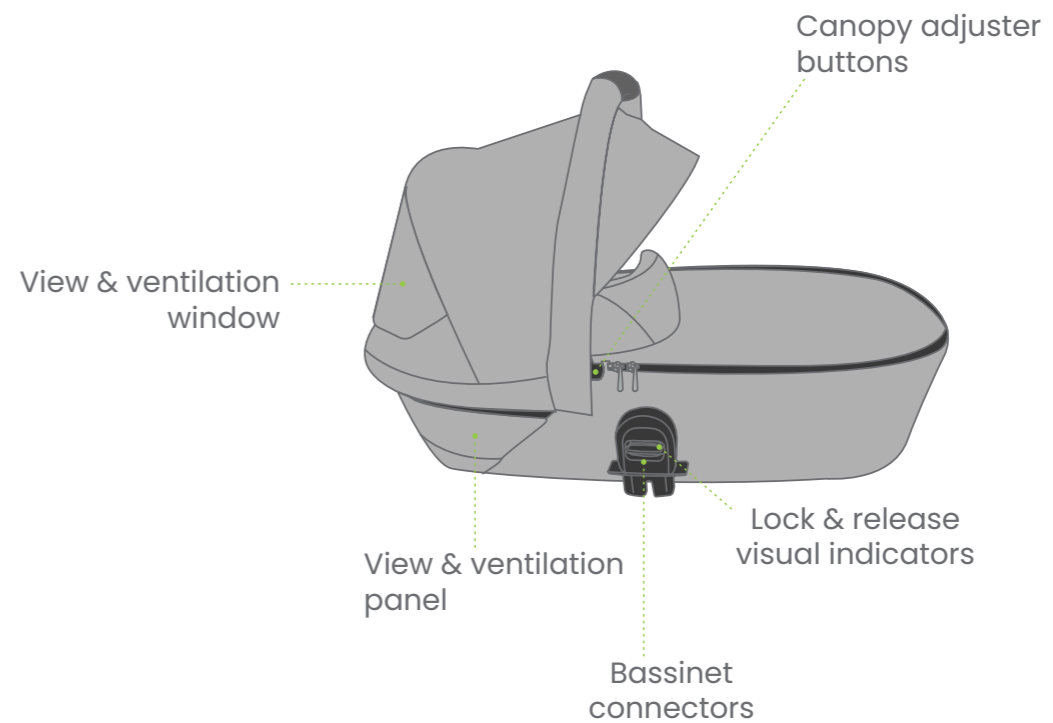
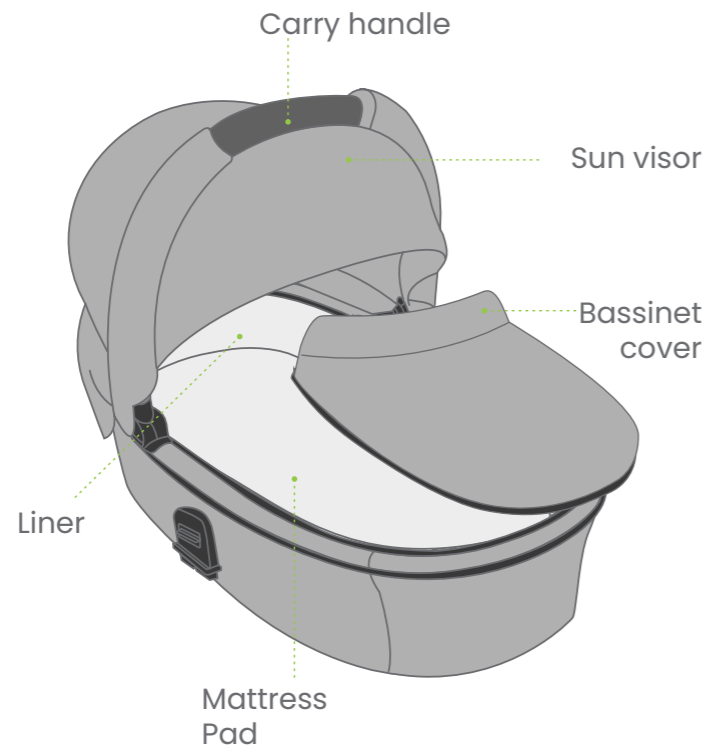

Bassinet Assembly

Opening the Bassinet

A

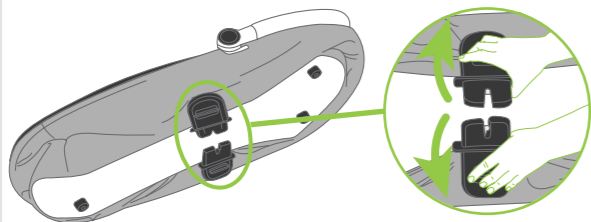

Rotate the bassinet connectors down the side of the bassinet.

B

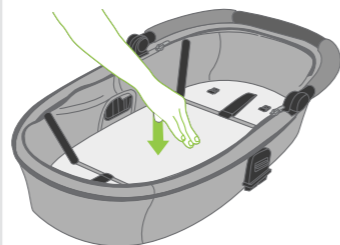

Press down on the base while keeping the connectors sitting straight.

C

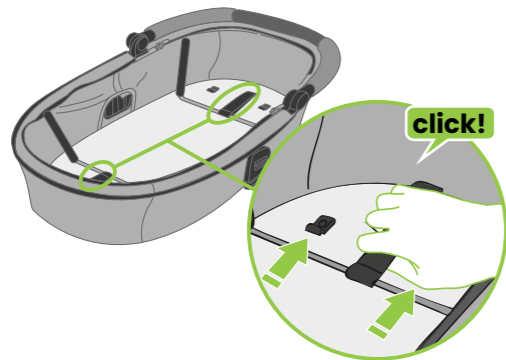

click! Pull the frame support rods at both ends of the bassinet by the straps until they lock under the clips.

Bassinet Assembly

Attaching the Liner

A

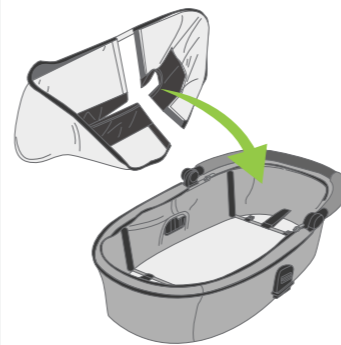

Place the liner inside the bassinet.

B



Zip the two bassinet liner pieces around the bassinet.

C

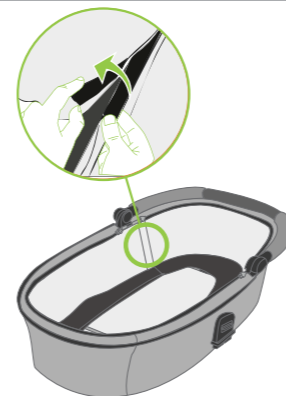

Use the hook & loop fastener to keep the two pieces together.

Inserting the Mattress Pad

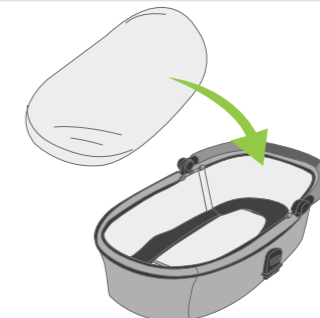

Place the mattress pad into the bassinet.

Bassinet Operation

Using the Canopy

⚠ CAUTION: ENSURE THE CANOPY ADJUSTER IS IN THE LOCKED POSITION BEFORE LIFTING THE BASSINET BY THE CARRY HANDLE.

A



Rotate the carry handle forward until it locks into position.

B

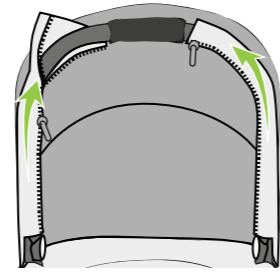

Place the canopy fabric over the top of the carry handle and zip around both sides of the carry handle.

C

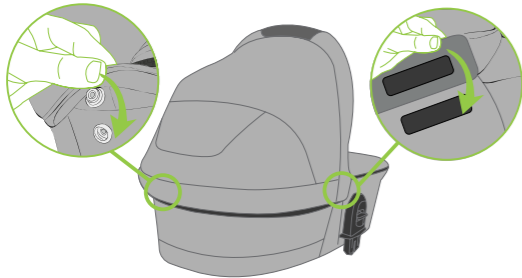

Use the hook & loop fasteners and press stud to secure the canopy to the bassinet.

Attaching the Bassinet Cover

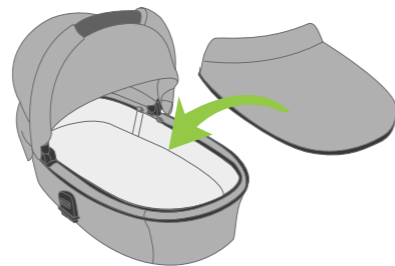

Place the bassinet cover over the bassinet and use the zippers to close the sides.

Bassinet Operation

IMPORTANT NOTE:

- Always remove your baby from the bassinet before installing or removing the bassinet.
- Always remove the bassinet before folding.

PLEASE NOTE: The bassinet can only be used in parent facing mode.

Attaching the Bassinet to the stroller frame

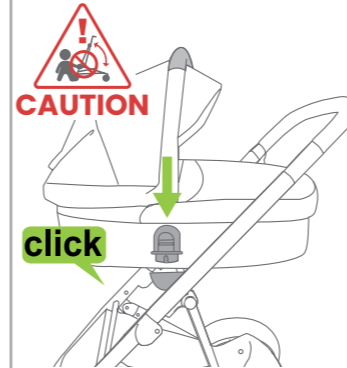

Align the bassinet connectors directly over the frame sockets and then push down until both connectors lock.



Note: A green indicator will display on both the sides of the bassinet when installed correctly.

Removing the Bassinet from the stroller frame

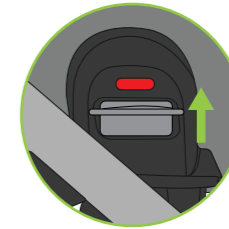

Push the bassinet release buttons up on both sides. The indicators will now display red.

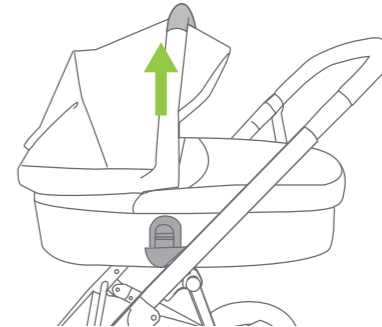

Lift the bassinet up from carry handle to remove from the frame.

Bassinet Operation

Using the View & Ventilation Panels

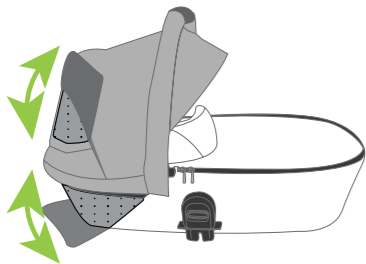

Lift canopy window flap up and unzip bottom panel to expose the mesh view & ventilation panels when required.

☺ **TIP:** The view & ventilation panels can be opened to cool and provide more air flow to the baby.

Bassinet Accessories (Sold Separately)

Attaching the Rain Cover

IMPORTANT NOTE:

- Ensure the rain cover is kept away from the child's face.
- Refit the rain cover if required to ensure your child is safe.

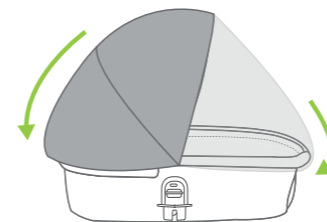

Fit the rain cover over the canopy and pull to the front then secure with elasticised end.

Attaching the Sun Shade

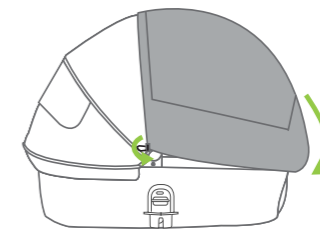

Fit the sun shade over the canopy front and secure the toggle and elastic loop around the canopy frame then pull to the front and secure with elasticised end.

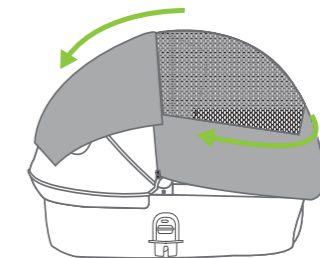

Lift the sun shade cover flap to use mesh panel for ventilation and open zipper to access the baby.

Care & Maintenance

General Maintenance & Repair

- Ensure all safety devices, locks, harness, and brakes are in working order.
- Ensure all joints and folding areas move freely as intended.
- Should any moving or locking parts become stiff or hard to operate, ensure these are free from tension, or dirt by wiping clean with a damp cloth to remove any dirt, sand, or debris. Allow to dry and lightly spray with a dry silicon lubricant. Please carefully read the lubricant instructions prior to use.
- Ensure wheels are regularly cleaned with a damp cloth by removing dirt, sand, or debris. Allow to dry and lightly spray the wheel pivot pin with a dry silicon lubricant to keep the wheels moving smoothly. Please carefully read the lubricant instructions prior to use.
- Regularly spray all moving parts with a dry silicon lubricant. Please carefully read the lubricant instructions prior to use.
- Ensure all connecting rivets and screws are secure.
Tighten if required.
- If there are compression marks on the tyres, use a domestic hair dryer to gently warm (DO NOT OVERHEAT) the tyre and the compression marks should slowly disappear.
- To maintain the safety and longevity of the

stroller, seek prompt repairs or replacement for bent, torn, worn, or broken parts. Do not continue to use the stroller if unsafe.

- All repairs should only be carried out by an authorised Britax repairer. Only Britax replacement parts should be used with the stroller. It may be unsafe to use parts supplied from another manufacturer.

General Tips

Do not store the stroller in your car for prolonged periods of time during summer as it may lead to damage to some of the plastics components.

Do not leave the stroller in direct sunlight for extended periods of time, as colours of some fabrics may fade, and tyres may deteriorate.

Do not fold or store the stroller if damp or wet, as fabric may develop mould or mildew. Always store the stroller inside in a dry, well-ventilated area.

Do not place heavy objects on top of the stroller as it may alter the shape.

Should you have any further questions on care & maintenance of the stroller, please contact our Consumer Service Team at: aunz-support@britax.com

Care & Maintenance

Cleaning

Fabrics

- Removable fabrics may be cleaned using lukewarm water and soap or mild detergent. Rinse thoroughly and allow to dry away from direct sunlight.
- Non-removable fabrics can be spot cleaned using a damp sponge and soap or mild detergent. Allow to dry completely before re-use or storage.
- Never use bleach, or abrasive cleaning products.
- **DO NOT** iron or dry clean.

NOTE: DO NOT place any of the stroller fabrics in the dryer. Allow to dry naturally, away from direct sunlight.

Frame

- Remove dirt and dust away from any moving mechanism.
- Clean frame with a soft damp cloth and soap or mild detergent and allow to dry thoroughly.
- **DO NOT** use abrasive cleaning products as it may cause stains, discolouration or scratches to the frame.
- **DO NOT** soak or submerge frame in water.
- **DO NOT** remove, dismantle or alter any part of the stroller mechanism or brakes.

Leatherette

- Spot clean with a damp soft cloth.
- **DO NOT** use a dripping wet cloth or wet the leatherette excessively.

Wheels

- Remove wheels from stroller.
- Clean with damp cloth and soap or mild detergent. Use brush to remove dirt and mud build up around the tyre. Allow to dry thoroughly before placing wheels back on the frame.
- If necessary lubricate wheel shaft with a small amount of lubricant before placing into the stroller.
- Ensure the stroller is cleaned thoroughly after using it on the beach as sand and salt can damage stroller mechanism, wheel assembly, causing premature wear and corrosion.

PLEASE NOTE:

Our product warranty does not cover any rust to the rivets or screws, if you are caught in the rain or at the beach always thoroughly dry the frame to avoid any rust damage.

Care & Maintenance

Just like servicing your car or bicycle, prams and strollers also need **regular maintenance checks**. These checks can improve product performance, extend the life of your stroller and help to provide you and your children a safe and smooth journey.



We recommend servicing your stroller every 6 months and completing an inspection once a month. To prolong the life of your stroller, a regular maintenance should be performed.

5 STEP CHECK LIST

1. **INSPECT SAFETY DEVICES** tether strap, frame lock, harness, buckle and brakes, and ensure all are in working order and free from dirt, sand, and debris.
2. **INSPECT** all connecting rivets and screws are secure.
3. **MAKE SURE FOLDING JOINTS** are free of dirt, dust, and debris by cleaning with a damp cloth, allow to dry and lightly spray with a dry silicon lubricant. Please carefully read the lubricant instructions prior to use.
4. **REMOVE WHEELS** and wipe clean with a damp cloth to remove any dirt, sand or debris. Allow to dry and lightly spray the wheel pivot pin with a dry silicon lubricant to keep the wheels moving smoothly. Please carefully read the lubricant instructions prior to use.
5. **ENSURE WHEN FOLDING AND STORING** to wipe down your stroller frame and allow to dry before storing in a dry place without direct sunlight.

Warranty

Australian Consumer Law

On all of our goods, you have the benefit of a statutory consumer guarantee. In summary, goods are guaranteed to be of “acceptable quality” (fit for purpose), goods are guaranteed to match any sample against which they are sold. These consumer guarantees are provided for by the Australian Consumer Law and, if you believe any one of these guarantees is not satisfied by a Britax product, you have rights under the Australian Consumer law to enforce that guarantee.

Your rights under the statutory consumer guarantees are set out in the **Australian Competition and Consumer Commission’s Consumer Guarantees – A Guide for Consumers**.

In addition to the statutory consumer guarantees, **Britax** offers its own company warranty on all of its products. You therefore have the option of seeking redress for defective or faulty product either under the **Britax** company warranty or the statutory guarantees.

After the **Britax** company warranty expires, you still have your rights under the statutory consumer guarantees.

International Warranty

Britax products are available through a network of retailers in Australia and New Zealand. If you are an international customer we do not offer a warranty service outside of these regions.

THIS PRODUCT IS NOT INTENDED FOR COMMERCIAL USE

Warranty

Did you know?

Registering your product online simplifies proof of purchase in the event of a warranty claim.

Head to our website to fill out the product registration form:

britax.com.au **britax.co.nz**



Making A Warranty Claim

Your rights under a **Britax** company warranty are separate from and independent of your rights under the statutory consumer guarantees. What you need to do to enforce your rights under a statutory consumer guarantee is set out in the

Australian Competition and Consumer Commission's Consumer Guarantees – A Guide for Consumers.

To make a claim under a **Britax** company warranty, please contact our customer service team on:

Australia: 1300 303 330 / **New Zealand:** 0508 688 822 *or* alternatively by email at: **aunz-support@britax.com**

You will be required to :

- Return the product to the place of purchase or to a designated repair agent;
- Present your receipt as proof of purchase;
- Identify the defect in the product; and
- Present the product to **Britax** for inspection on request.

Britax will advise you whether the product is covered by the **Britax** company warranty. **Britax's** decision of whether a product is covered by a **Britax** company warranty is final.

Britax will act reasonably when determining whether a product is covered by a company warranty.

Series No. RM-H216F
Art No. 4002422_B

Britax Childcare Pty. Ltd.

A.B.N. 55 006 773 600

Level 4, 650 Lorimer Street, Port Melbourne, Victoria 3207, Australia

Phone: (03) 9288 7288 **Fax:** (03) 9311 5798

Customer Service

Australia: 1300 303 330 / New Zealand: 0508 688 822

Due to our continuing program of development, Britax reserves the right to alter the specifications, color or design without any further notice.

The **Britax** trademark is the property of Britax Childcare Holdings Limited – UK.

Visit the **Britax** website at: **britax.com.au or britax.co.nz** or email us at **aunz-support@britax.com**

Due to the variations in the style and design of our products the illustrations used in this instruction booklet are generic.

This product is designed to comply with:

AS/NZS 8811.1:2013 “Methods of testing infant products. Method 1: Sleep surfaces – Test for firmness”

EN 1466:2014/AC:2015 “Safety requirements and test methods for child use and care articles – Carry cots and stands”

Australian Standard AS 2088:2022 “Prams and Strollers- Safety Requirements”

Copyright © 2021 Britax Childcare Pty. Ltd. Australia